

## UTP3-GSW0802T-POE



- Main Function: Provide 8\*10/100/1000Base-T Ethernet ports(PoE) , 2\*10/100/1000Base-T Ethernet ports;
- Compliance with standards: IEEE802.3 、 IEEE802.3u、 IEEE802.3ab、 IEEE802.3z、 IEEE802.3X、 IEEE802.3af/at;
- PoE Power Display: Support 8 LED digital tube display machine PoE power usage. whole machine reaches 135W PoE power output;
- One-key Smart: Support three kinds of working modes (Default, VLAN, CCTV);
- Protection: Support 6KV surge immunity, EFT testing standard;
- Operation Environment: Support -10°C~45°C wide-temperature;



## Introduction

8 Ports Gigabit PoE Ethernet Switch is an unmanaged Ethernet switch designed for Gigabit Ethernet access and PoE applications. It provides eight Gigabit downlink ports, and two Gigabit uplink Ethernet port. The eight downlink ports support 802.3af/at standard and feature Max 30W PoE power output of single port, Max 135W of whole machine. Support three kinds of work mode (Default, VLAN, CCTV), and supports 8 LED digital tube to display machine PoE power usage. It can be widely used in security surveillance, hotels, schools, SMB engineering and other occasions.

## Application

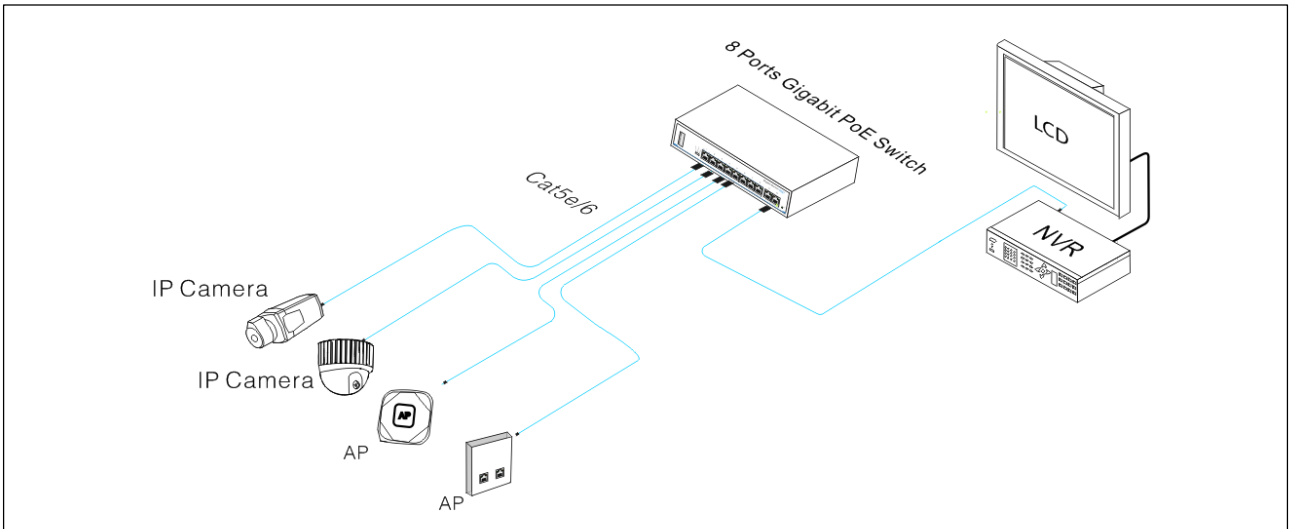

## Physical Features

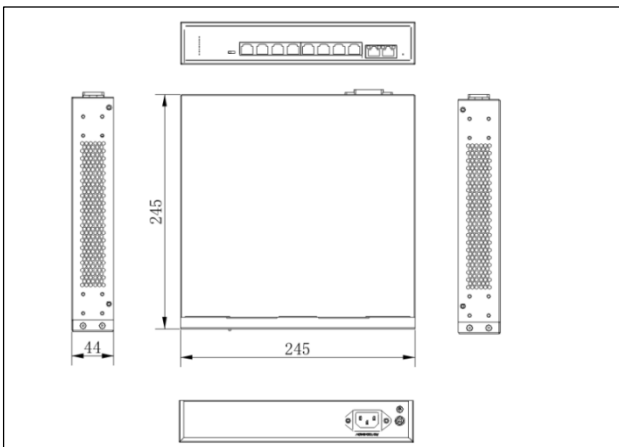

## Interface drawing

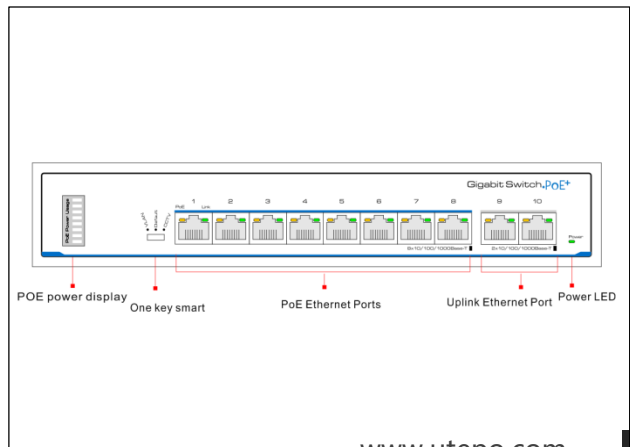

**Specification**

Model	UTP3-GSW0802T-POE
Downstream Ports	8* 10/100/1000Base-T (PoE)
Uplink Ports	2x 10/100/1000Base-T Ethernet Ports
Network Standard	IEEE802.3、IEEE802.3u、IEEE802.3ab、IEEE802.3 X
Switch Capacity	20Gbps
Throughput	14Mpps
Switch Processing Scheme	Store and Forward
Memory Buffer	1M
MAC Table	4K
PoE Standard	802.3af/at(PSE)
PoE Type	End-span
Power Pin Assignment	1/2(+), 3/6(-)
PoE Power Output	54V DC , 30 watts max
PoE Budget	135 watts max
PoE power display	Support 8 LED digital tube to display machine PoE power usage
One-key Smart	Default: All ports are free to communicate
	VLAN: The down ports are isolated from each other
	CCTV: Optimize flow control for port isolation
Lightning protection	6KV Execute : IEC61000-4-5
ESD	6KV Contact discharge 8KV Air discharge Execute : IEC61000-4-2
Power Supply	AC 110V~240V
Power Dissipation	<10W
Work temperature	-10°C~45°C
Storage temperature	-40°C~85°C
Humidity(Non-condensin)	5%-95%
Dimension ( L×W×H )	245mm×245mm×44mm
Weight	1Kg
Regulator	CE、FCC、ROHS

**Package List**

Designation	Quantity
UTP3-GSW0802T-POE	1
AC Power Cable	1
Accessory	1
User Manual	1

**Related Products**

Designation	Model
4 Ports Full Gigabit PoE Switch	UTP1-GSW0401-TP60
8 Ports Full Gigabit PoE Switch	UTP3-GSW0802-TP120
8 Ports Full Gigabit PoE Switch	UTP3-GSW0802-STP120
8 Ports Full Gigabit PoE Switch	UTP3-GSW0802S-POE